

WBS NO: 2025CPT.01.07.10281, ETC.

CONTRACT: DA00615

STATE OF NORTH CAROLINA  
DIVISION OF HIGHWAYS

**DARE**

STATE	STATE PROJECT REFERENCE NUMBER	SHEET NO.
NC	2025CPT.01.07.10281, ETC.	1
STATE PROJECT NUMBER		DESCRIPTION
2025CPT.01.07.10281		P.E., CONST.

*TYPE OF WORK: MILLING, RESURFACING, SHOULDER RECONSTRUCTION, & PAVEMENT MARKINGS*

MAP	ROUTE	FROM	TO
01	NC 12	Barrier Island Station	Currituck Co.

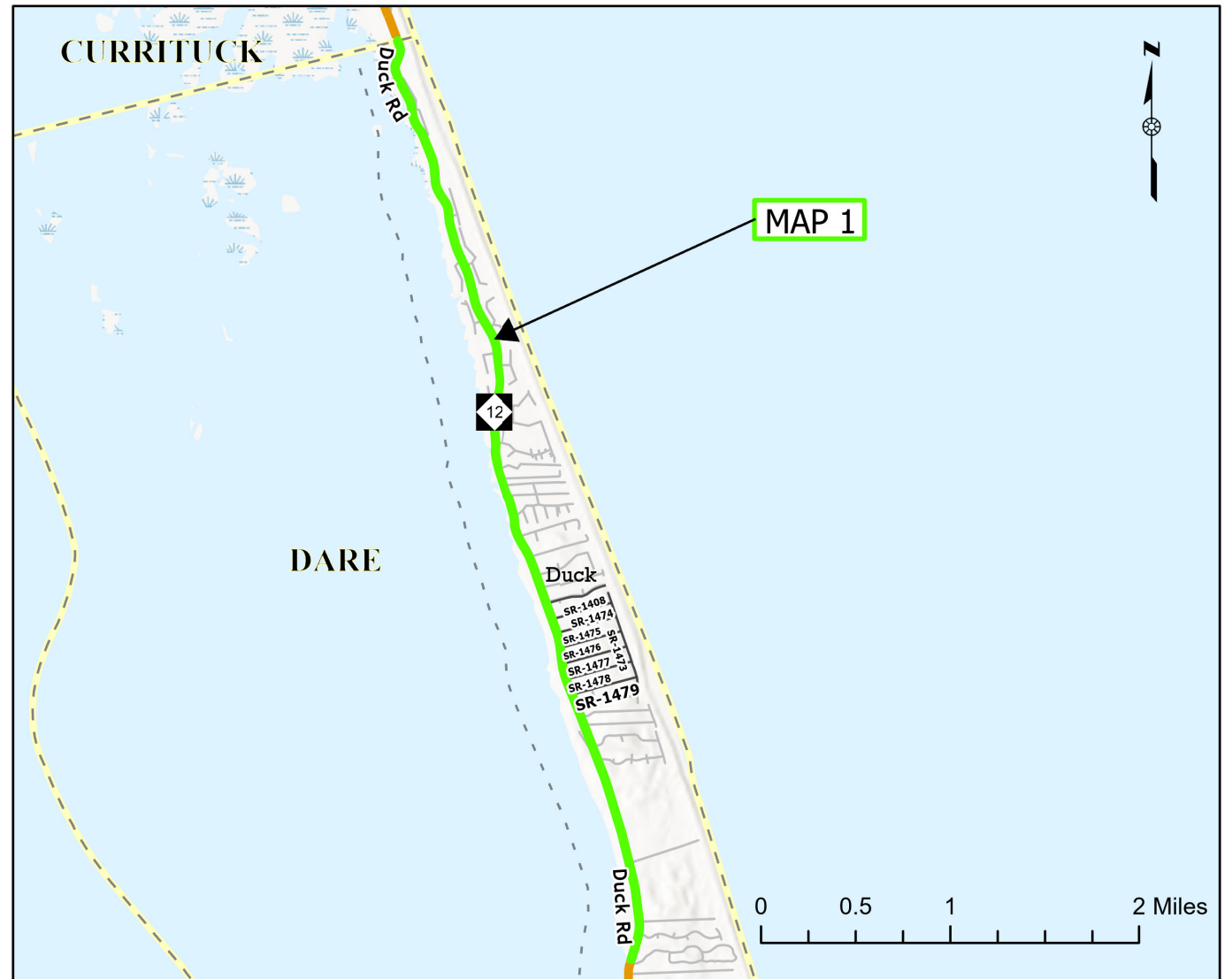

**PROJECT LENGTH**

MAP	MILES
01	4.112

Prepared in the Office of:  
**DIVISION OF HIGHWAYS**  
113 AIRPORT DR., EDENTON, NC 27932

**B. N. BRASWELL, PE**  
DIV. PROJ. DEVELOPMENT ENGINEER

**M. S. WINSLOW**  
DIVISION CONTRACT ENGINEER

**J. S. ABEL, JR.**  
DIVISION PROJECT TEAM LEAD

**D. H. STALLINGS**  
DIVISION DESIGN ENGINEER



WBS NO: 2025CPT.01.07.10281, ETC.

CONTRACT: DA00615

STATE OF NORTH CAROLINA  
DIVISION OF HIGHWAYS

**DARE**

STATE	STATE PROJECT REFERENCE NUMBER	SHEET NO.
NC	2025CPT.01.07.10281, ETC.	2
STATE PROJECT NUMBER		DESCRIPTION
2025CPT.01.07.20282		P.E., CONST.

*TYPE OF WORK: MILLING, RESURFACING, SHOULDER RECONSTRUCTION, & PAVEMENT MARKINGS*

MAP	ROUTE	FROM	TO
02	SR 1408-Dianne St	Dead End	NC 12
03	SR 1473-Buffell Head Road	Dead End	Dead End
04	SR 1474-Squaw Drive	SR 1473-Buffell Head Rd.	NC 12
05	SR 1475-Spigtail Drive	SR 1473-Buffell Head Rd.	NC 12
06	SR 1476-Canvasback Drive	SR 1473-Buffell Head Rd.	NC 12
07	SR 1477-Wood Duck Drive	SR 1473-Buffell Head Rd.	NC 12
08	SR 1478-Pintail Drive	SR 1473-Buffell Head Rd.	NC 12
09	SR 1479-Widgeon Drive	SR 1473-Buffell Head Rd.	NC 12

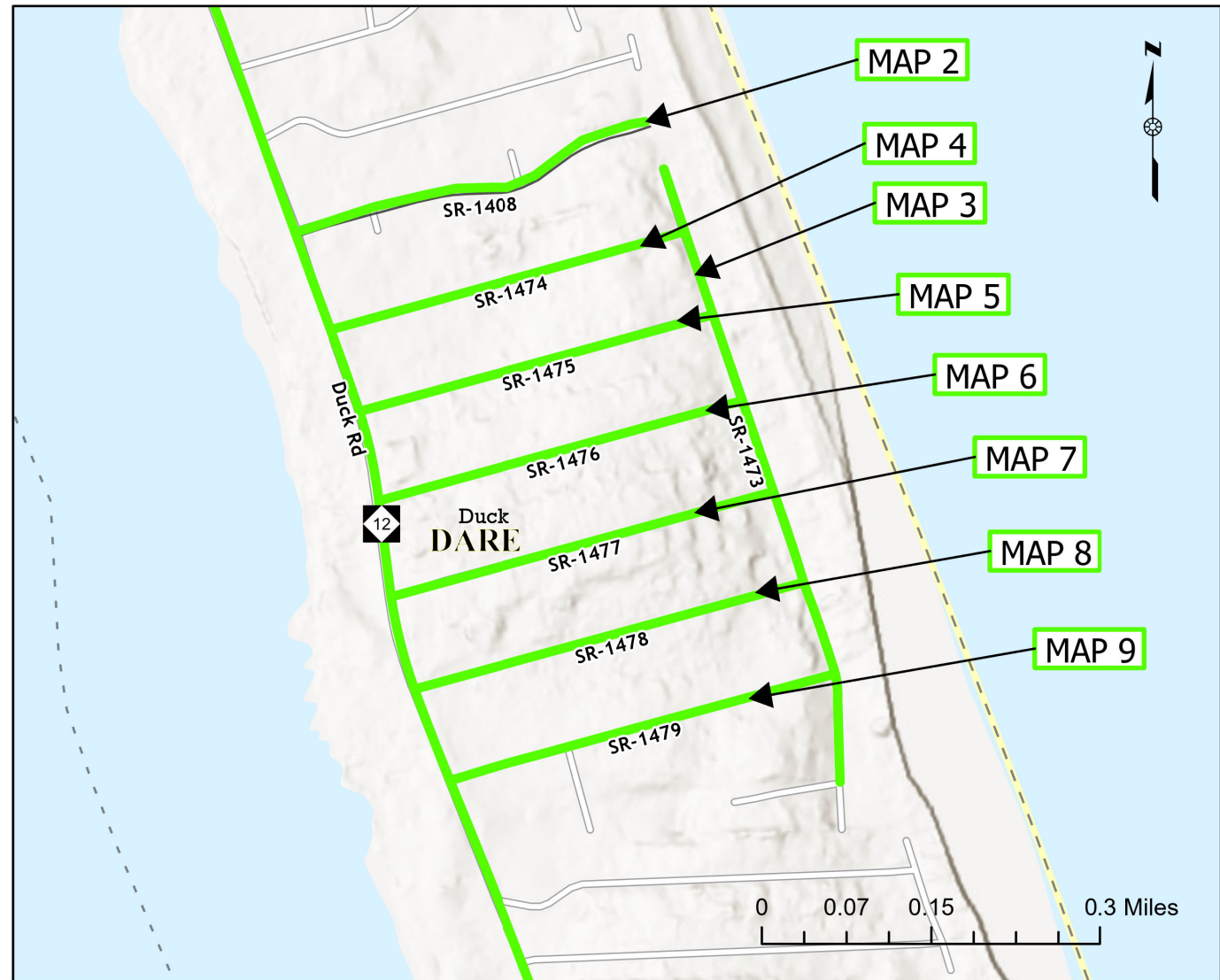

**PROJECT LENGTH**

MAP	MILES	MAP	MILES
02	0.269	06	0.27
03	0.458	07	0.284
04	0.263	08	0.289
05	0.263	09	0.287

Prepared in the Office of:  
**DIVISION OF HIGHWAYS**  
113 AIRPORT DR., EDENTON, NC 27932

**B. N. BRASWELL, PE**  
DIV. PROJ. DEVELOPMENT ENGINEER

**M. S. WINSLOW**  
DIVISION CONTRACT ENGINEER

**J. S. ABEL, JR.**  
DIVISION PROJECT TEAM LEAD

**D. H. STALLINGS**  
DIVISION DESIGN ENGINEER



PAVEMENT SCHEDULE

C1	PROP. APPROX. 1.5" ASPHALT CONCRETE SURFACE COURSE, TYPE S9.5C, AT AN AVERAGE RATE OF 168 LBS. PER SQ. YD.
V1	INCIDENTAL MILLING
V2	MILLING ASPHALT PAVEMENT, 1.50" DEPTH
T	SHOULDER RECONSTRUCTION
U	EXISTING PAVEMENT

NOTES:

- \* ALL INTERSECTING ROADS ARE TO BE RESURFACED TO THE ENDS OF THEIR RADII, THE MAIN LINE RIGHT OF WAY OR AS DIRECTED BY THE ENGINEER. THIS SHALL INCLUDE ANY TAPERS AND TURN LANES LOCATED BOTH ON THE MAIN LINE OR INTERSECTING PAVED ROADWAY.
- \* EDGES, PAVEMENT WIDENING, INTERSECTIONS AND BRIDGE FLARES ARE INCLUDED IN THE SUMMARY OF QUANTITIES.
- \* 1.5" OF S9.5C TO BE APPLIED THE FULL WIDTH OF THE ROADWAY
- \* CONTRACTOR SHALL PERFORM PATCHING EXISTING PAVEMENT, FULL DEPTH BEFORE APPLICATION OF 1.5" OF S9.5C
- \* CONTRACTOR SHALL INSTALL 6" PROFILED PAVEMENT MARKINGS ON EDGE LINES IN ACCORDANCE WITH *STANDARD SPECIFICATIONS* ON MAP 1 ONLY.
- \* SHOULDER WEDGE SHALL BE USED ON ALL ROADS 22' OR WIDER OR AS DIRECTED BY THE ENGINEER

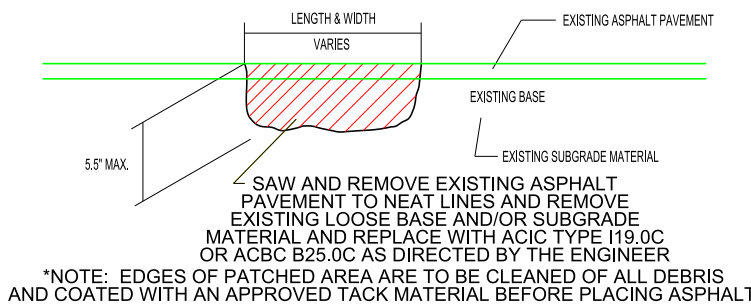

**PATCHING EXISTING PAVEMENT (FULL DEPTH)**

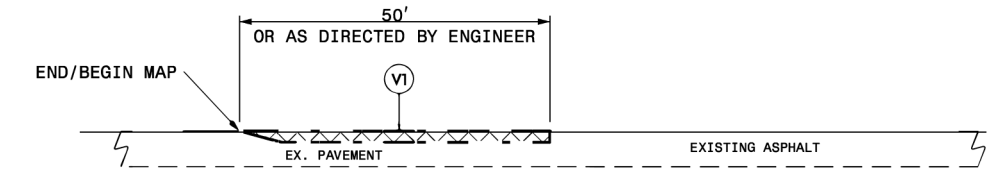

**DETAIL 1**

- NOTE:
1. INCLUDES INCIDENTAL MILLING AT THE ENDS OF MAIN LINE SECTIONS, OR AS DIRECTED BY THE ENGINEER.
  2. PAVE TO THE END OF THE MILLED SURFACE TO CREATE A SMOOTH TRANSITION.

\*NOTE: EDGES OF PATCHED AREA ARE TO BE CLEANED OF ALL DEBRIS AND COATED WITH AN APPROVED TACK MATERIAL BEFORE PLACING ASPHALT.

**PATCHING EXISTING PAVEMENT (FULL DEPTH)**

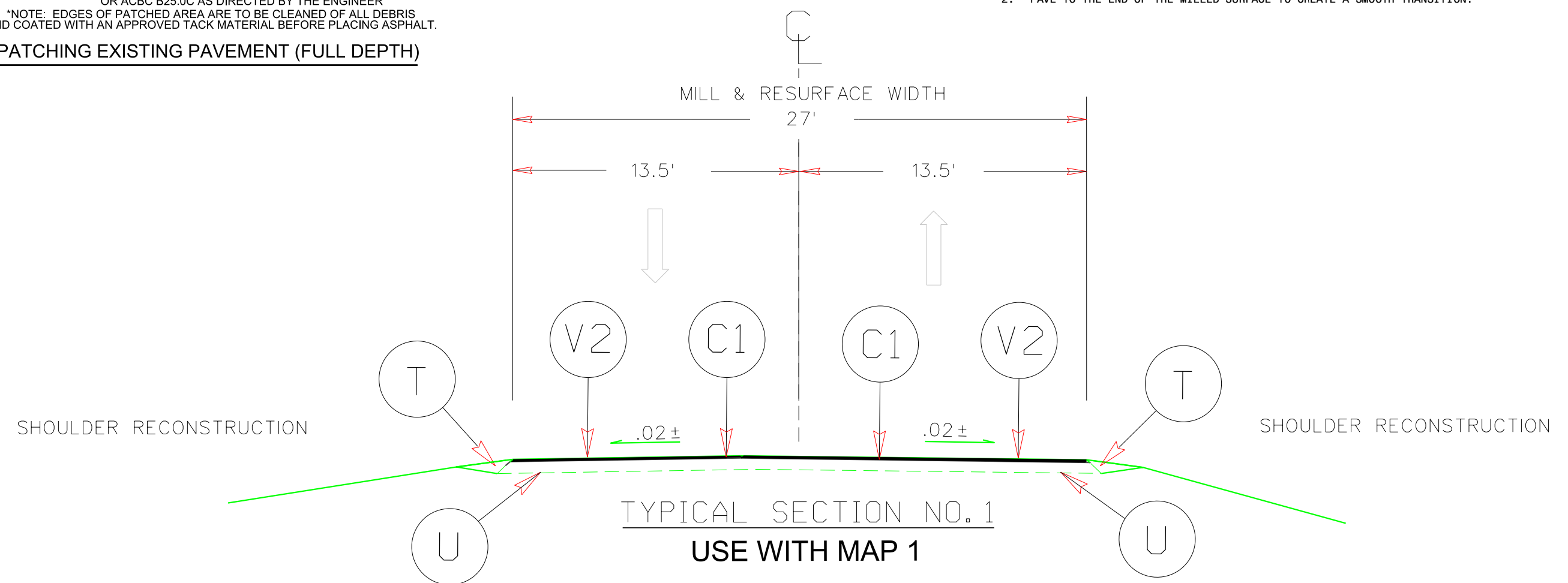

**TYPICAL SECTION NO. 1**  
**USE WITH MAP 1**

PAVEMENT SCHEDULE

C2	PROP. APPROX. 1.25" ASPHALT CONCRETE SURFACE COURSE, TYPE S9.5B, AT AN AVERAGE RATE OF 138 LBS. PER SQ. YD.
U	EXISTING PAVEMENT

**NOTES:**

- \* ALL INTERSECTING ROADS ARE TO BE RESURFACED TO THE ENDS OF THEIR RADII, THE MAIN LINE RIGHT OF WAY OR AS DIRECTED BY THE ENGINEER. THIS SHALL INCLUDE ANY TAPERS AND TURN LANES LOCATED BOTH ON THE MAIN LINE OR INTERSECTING PAVED ROADWAY.
- \* EDGES, PAVEMENT WIDENING, INTERSECTIONS AND BRIDGE FLARES ARE INCLUDED IN THE SUMMARY OF QUANTITIES.
- \* 1.25" OF S9.5B TO BE APPLIED THE FULL WIDTH OF THE ROADWAY

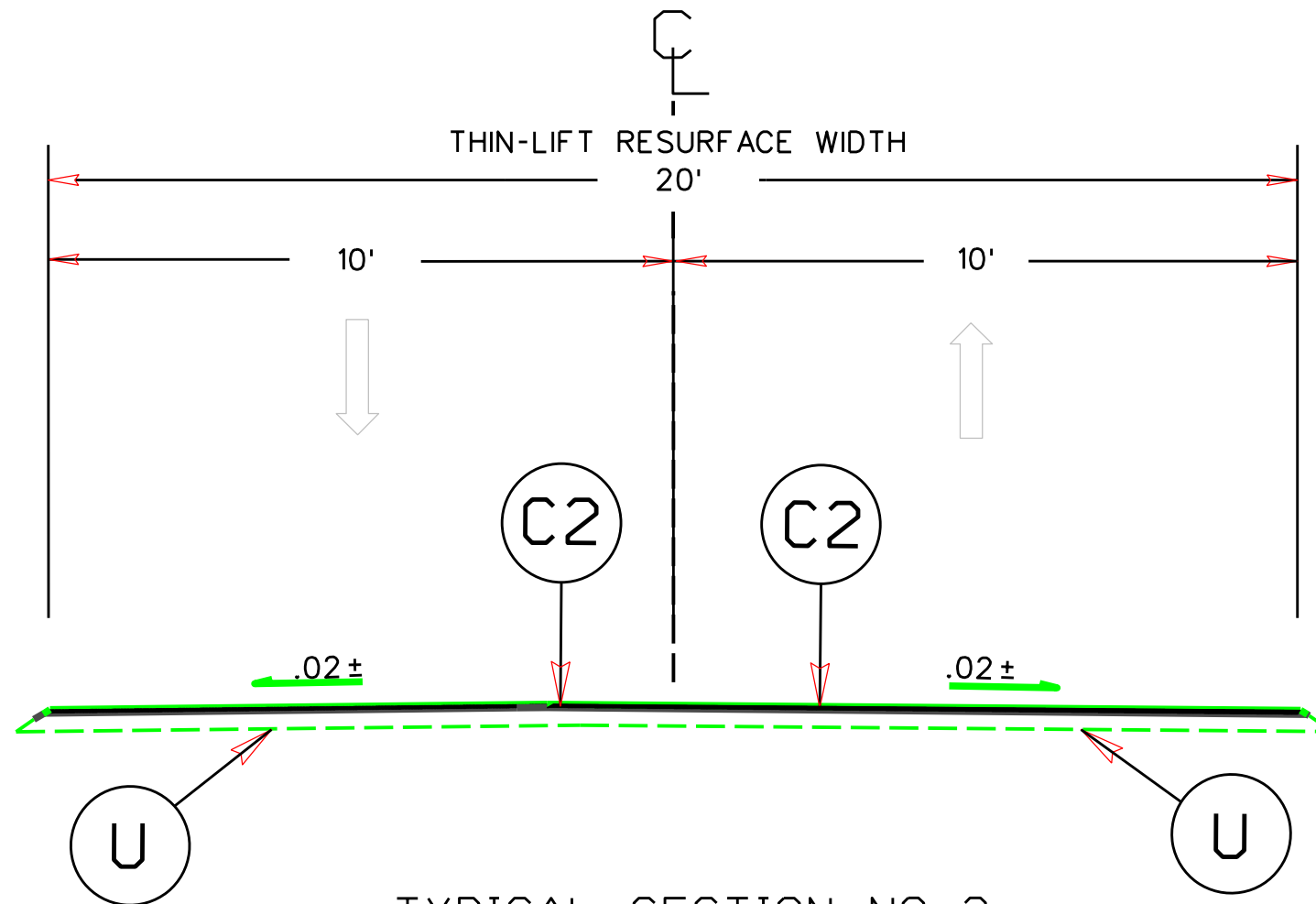

TYPICAL SECTION NO. 2  
USE WITH MAPS 2 - 9



PROJECT NO.	SHEET NO.	TOTAL NO.
2025CPT.01.07.10281, ETC.	5	

### SUMMARY OF QUANTITIES

PROJECT NO	COUNTY	MAP NO	ROUTE	DESCRIPTION	TYP NO	LANES	LANE TYPE	LENGTH	WIDTH	BEGIN MP	END MP	0000100000-N	1220000000-E	1245000000-E	1297000000-E	1330000000-E	1519000000-E	1523000000-E	1575000000-E	1705000000-E	2845000000-N	6000000000-E	6071012000-E	6084000000-E	6117000000-N	
								MI	FT			MOBILIZATION	INCIDENTAL STONE BASE	SHOULDER RECONSTRUCTION	MILLING ASPHALT PAVEMENT (1½")	INCIDENTAL MILLING	ASPHALT CONC SURFACE COURSE, S9.5B	ASPHALT CONC SURFACE COURSE, S9.5C	ASPHALT BINDER FOR PLANT MIX	PATCHING EXISTING PAVEMENT (FULL DEPTH)	ADJUSTMENT OF METER OR VALVE BOXES	TEMPORARY SILT FENCE	COIR FIBER WATTLE	SEEDING & MULCHING	RESPONSE FOR EROSION CONTROL	
													TONS	SMI	SY	SY	TONS	TONS	TONS	TON	EA	LF	LF	ACR	EA	
2025CPT.01.07.10281	Dare	1	NC-12 E / DUCK RD	FROM BARRIER ISLAND STATION TO DARE COUNTY LINE		2	2WU	4.112	27	80.11	84.222	1	24	8.22	68,835	1,495		6,120	369	156	2	100	20	4.0	1	
<b>TOTAL FOR PROJ NO. 2025CPT.01.07.10281</b>								<b>4.112</b>						<b>24</b>	<b>8.22</b>	<b>68,835</b>	<b>1,495</b>		<b>6,120</b>	<b>369</b>	<b>156</b>	<b>2</b>	<b>100</b>	<b>20</b>	<b>4.0</b>	<b>1</b>
2025CPT.01.07.20282	Dare	2	SR-1408 / DIANNE ST	FROM DEAD END TO NC 12		2	2WU	0.269	20	0	0.269	*					260		17							
2025CPT.01.07.20282	Dare	3	SR-1473 / BUFFELL HEAD RD	FROM DEAD END TO DEAD END		2		0.458	20	0	0.458	*	6				475		31							
2025CPT.01.07.20282	Dare	4	SR-1474 / OLD SQUAW DR	FROM SR 1473-BUFFELL HEAD RD. TO NC 12		2	2WU	0.263	20	0	0.263	*	1				235		15							
2025CPT.01.07.20282	Dare	5	SR-1475 / SPRIGTAIL DR	FROM SR 1473-BUFFELL HEAD RD. TO NC 12		2		0.263	20	0	0.263	*					235		15							
2025CPT.01.07.20282	Dare	6	SR-1476 / CANVASBACK DR	FROM SR 1473-BUFFELL HEAD RD. TO NC 12		2	2WU	0.27	20	0	0.27	*	6				241		16							
2025CPT.01.07.20282	Dare	7	SR-1477 / WOOD DUCK DR	FROM SR 1473-BUFFELL HEAD RD. TO NC 12		2	2WU	0.284	20	0	0.284	*					253		16							
2025CPT.01.07.20282	Dare	8	SR-1478 / PINTAIL DR	FROM SR 1473-BUFFELL HEAD RD. TO NC 12		2	2WU	0.289	20	0	0.289	*	2				258		17		1					
2025CPT.01.07.20282	Dare	9	SR-1479 / WIDGEON DR	FROM SR 1473-BUFFELL HEAD RD. TO NC 12		2	2WU	0.287	20	0	0.287	*					261		17							
<b>TOTAL FOR PROJ NO. 2025CPT.01.07.20282</b>								<b>2.383</b>						<b>15</b>				<b>2,218</b>		<b>144</b>		<b>1</b>				
<b>GRAND TOTAL</b>								<b>6.495</b>					<b>1</b>	<b>39</b>	<b>8.22</b>	<b>68,835</b>	<b>1,495</b>	<b>2,218</b>	<b>6,120</b>	<b>513</b>	<b>156</b>	<b>3</b>	<b>100</b>	<b>20</b>	<b>4.0</b>	<b>1</b>

PROJECT NO.	SHEET NO.	TOTAL NO.
2025CPT.01.07.10281, ETC.	6	

**THERMOPLASTIC AND PAINT QUANTITIES**

PROJECT NO	COUNTY	MAP NO	ROUTE	DESCRIPTION	TYP NO	LANES	LANE TYPE	LENGTH	WIDTH	BEGIN MP	END MP	4413000000-E	4457000000-N	4688000000-E	4695000000-E		4700000000-E	4709000000-E	4810000000-E		4820000000-E		4825000000-E	4835000000-E	4890000000-E	4895000000-N
												WORK ZONE ADVANCE / GENERAL WARNING SIGNING	TEMPORARY TRAFFIC CONTROL (SP)	THERMOPLASTIC PAVEMENT MARKING LINES (6", 90 MILS) YELLOW	THERMOPLASTIC PAVEMENT MARKING LINES (8", 90 MILS) YELLOW	THERMOPLASTIC PAVEMENT MARKING LINES (8", 90 MILS) WHITE	THERMOPLASTIC PAVEMENT MARKING LINES (12", 90 MILS)	THERMO PAVEMENT MARKING LINES (24" 90 MILS) (SP)	PAINT PAVEMENT MARKING LINES (4") WHITE	PAINT PAVEMENT MARKING LINES (4") YELLOW	PAINT PAVEMENT MARKING LINES (8") WHITE	PAINT PAVEMENT MARKING LINES (8") YELLOW	PAINT PAVEMENT MARKING LINES (12")	PAINT PAVEMENT MARKING LINES (24")	THERMOPLASTIC PROFILED PAVEMENT MARKING LINES, 6"	GENERIC PAVEMENT MARKING ITEM POLYCARBONATE H-SHAPED MARKER
								MI	FT			SF	LS	LF	LF	LF	LF	LF	LF	LF	LF	LF	LF	LF	LF	EA
2025CPT.01.07.10281	Dare	1	NC-12 E / DUCK RD	FROM BARRIER ISLAND STATION TO DARE COUNTY LINE		2	2WU	4.112	27	80.11	84.222	182	1.00	25,952	248	248		340	41,522	25,952	248	248		340	41,522	271
<b>TOTAL FOR PROJ NO. 2025CPT.01.07.10281</b>								<b>4.112</b>				<b>182</b>		<b>25,952</b>	<b>248</b>	<b>248</b>		<b>340</b>	<b>41,522</b>	<b>25,952</b>	<b>248</b>	<b>248</b>		<b>340</b>	<b>41,522</b>	<b>271</b>
														496				67,474		496						
2025CPT.01.07.20282	Dare	2	SR-1408 / DIANNE ST	FROM DEAD END TO NC 12		2	2WU	0.269	20	0	0.269		*				95	160					95	160		
2025CPT.01.07.20282	Dare	3	SR-1473 / BUFFELL HEAD RD	FROM DEAD END TO DEAD END		2		0.458	20	0	0.458		*													
2025CPT.01.07.20282	Dare	4	SR-1474 / OLD SQUAW DR	FROM SR 1473-BUFFELL HEAD RD. TO NC 12		2	2WU	0.263	20	0	0.263		*				75	122					75	122		
2025CPT.01.07.20282	Dare	5	SR-1475 / SPRIGTAIL DR	FROM SR 1473-BUFFELL HEAD RD. TO NC 12		2		0.263	20	0	0.263		*				75	122					75	122		
2025CPT.01.07.20282	Dare	6	SR-1476 / CANVASBACK DR	FROM SR 1473-BUFFELL HEAD RD. TO NC 12		2	2WU	0.27	20	0	0.27		*				75	122					75	122		
2025CPT.01.07.20282	Dare	7	SR-1477 / WOOD DUCK DR	FROM SR 1473-BUFFELL HEAD RD. TO NC 12		2	2WU	0.284	20	0	0.284		*				85	138					85	138		
2025CPT.01.07.20282	Dare	8	SR-1478 / PINTAIL DR	FROM SR 1473-BUFFELL HEAD RD. TO NC 12		2	2WU	0.289	20	0	0.289		*				85	138					85	138		
2025CPT.01.07.20282	Dare	9	SR-1479 / WIDGEON DR	FROM SR 1473-BUFFELL HEAD RD. TO NC 12		2	2WU	0.287	20	0	0.287		*				85	146					85	146		
<b>TOTAL FOR PROJ NO. 2025CPT.01.07.20282</b>								<b>2.383</b>									<b>575</b>	<b>948</b>					<b>575</b>	<b>948</b>		
<b>GRAND TOTAL</b>								<b>6.495</b>				<b>182</b>	<b>1.000</b>	<b>25,952</b>	<b>248</b>	<b>248</b>	<b>575</b>	<b>1,288</b>	<b>41,522</b>	<b>25,952</b>	<b>248</b>	<b>248</b>	<b>575</b>	<b>1,288</b>	<b>41,522</b>	<b>271</b>
														496				67,474		496						

NOTES: Less than 5' - 10' undisturbed buffer from ROW, ditchline, water feature, or drainage inlet, add BMP.

BMP Options: Wattle or Silt Fence

# EROSION CONTROL DETAIL

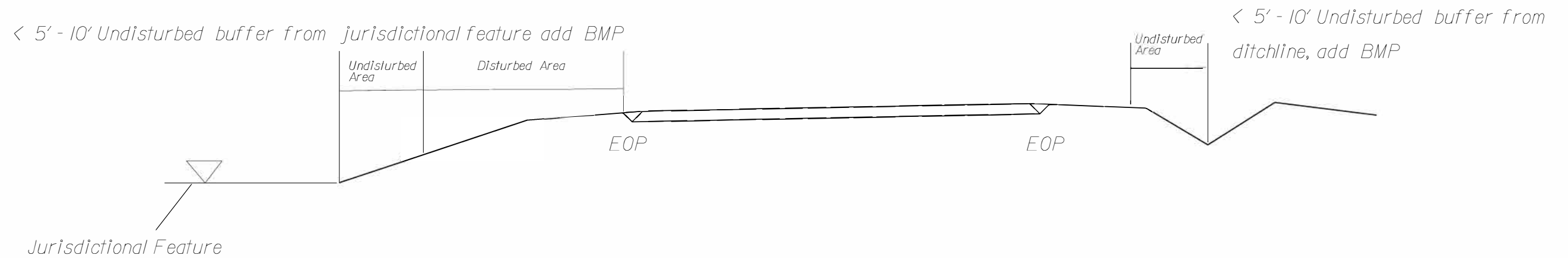
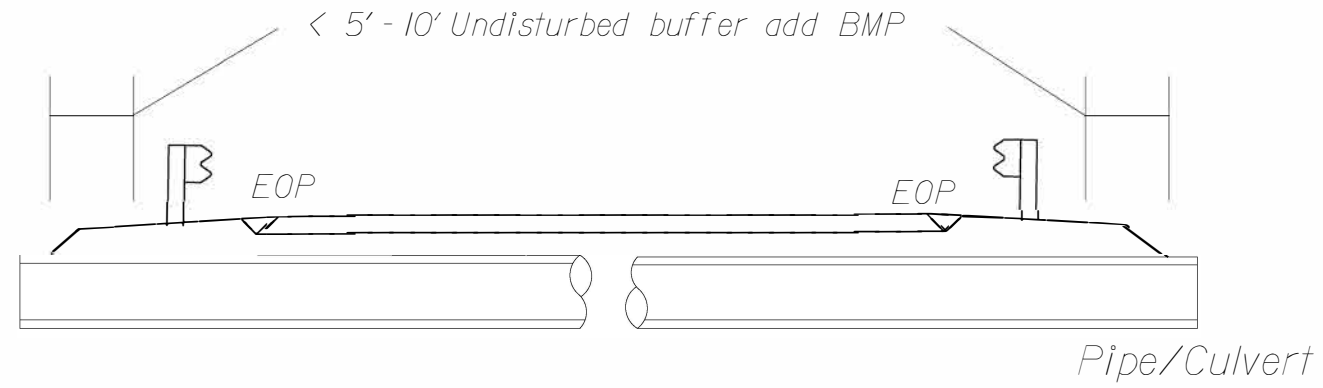

Use BMP's if shoulders and/or frontslopes and/or ditchline and/or backslopes are disturbed

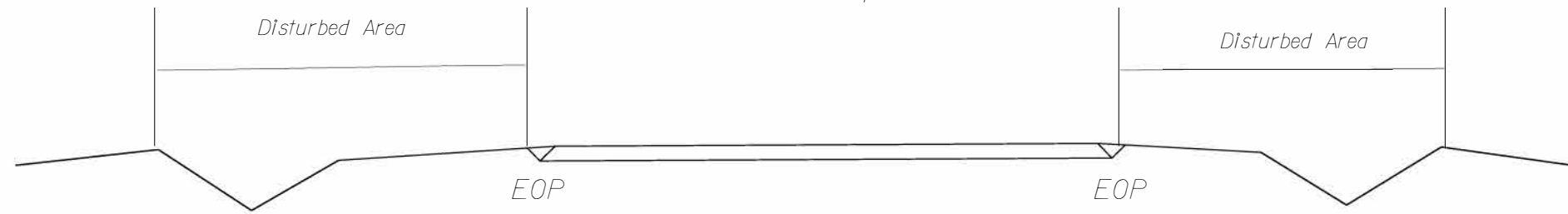

< 5' - 10' Undisturbed buffer from inlet, add wattle

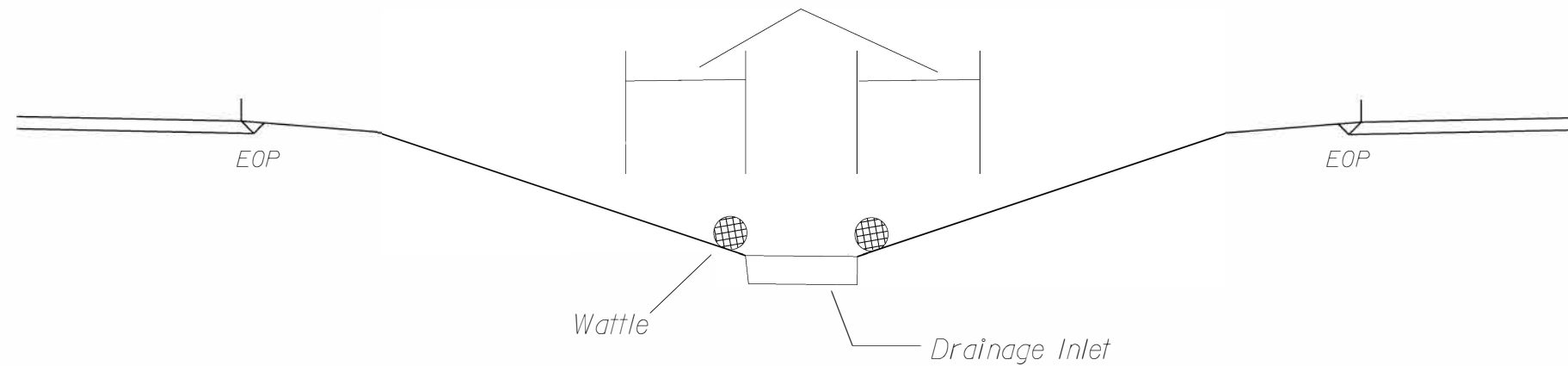

NOT TO SCALE



# COIR FIBER WATTLE DETAIL

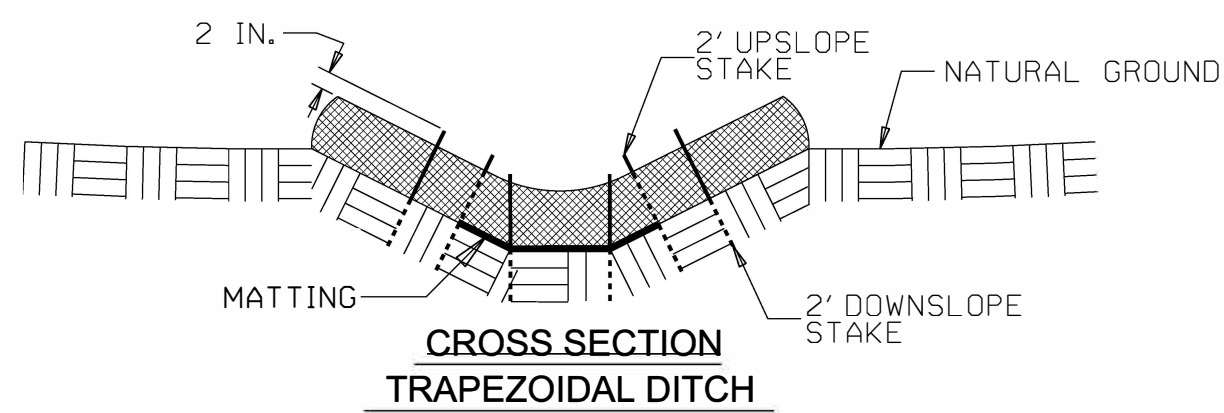
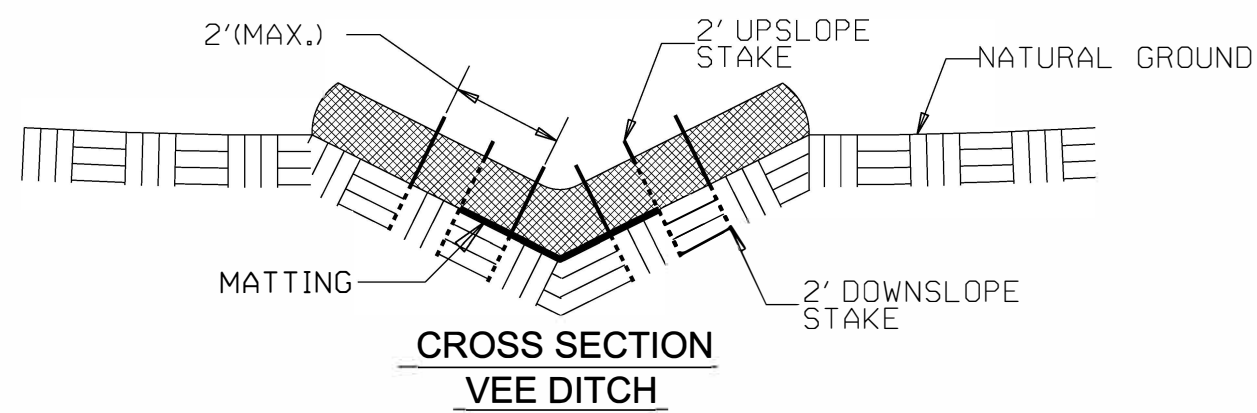
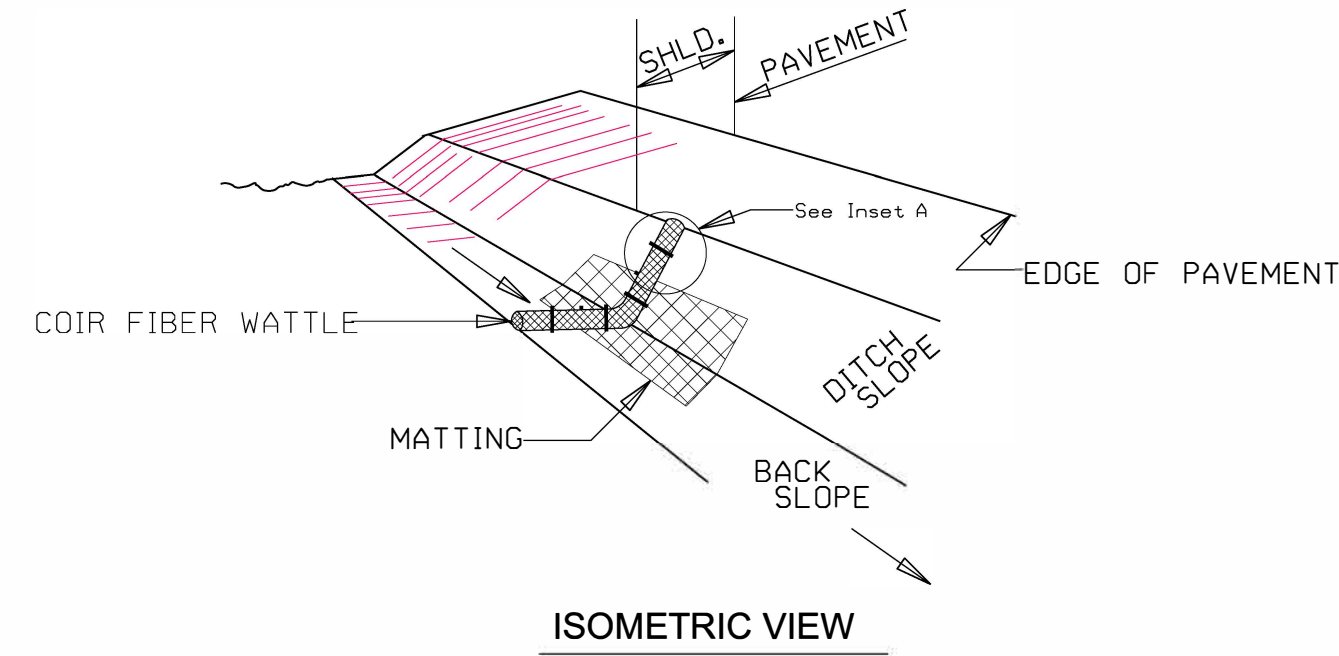

**NOTES:**

USE MINIMUM 12 IN. DIAMETER COIR FIBER (COCONUT FIBER) WATTLE.

USE 2 FT. WOODEN STAKES WITH A 2 IN. BY 2 IN. NOMINAL CROSS SECTION.

ONLY INSTALL WATTLE(S) TO A HEIGHT IN DITCH SO FLOW WILL NOT WASH AROUND WATTLE AND SCOUR DITCH SLOPES AND AS DIRECTED.

INSTALL A MINIMUM OF 2 UPSLOPE STAKES AND 4 DOWNSLOPE STAKES AT AN ANGLE TO WEDGE WATTLE TO BOTTOM OF DITCH.

PROVIDE STAPLES MADE OF 0.125 IN. DIAMETER STEEL WIRE FORMED INTO A U SHAPE NOT LESS THAN 12" IN LENGTH.

INSTALL STAPLES APPROXIMATELY EVERY 1 LINEAR FOOT ON BOTH SIDES OF WATTLE AND AT EACH END TO SECURE IT TO THE SOIL.

INSTALL MATTING IN ACCORDANCE WITH SECTION 1631 OF THE STANDARD SPECIFICATIONS.

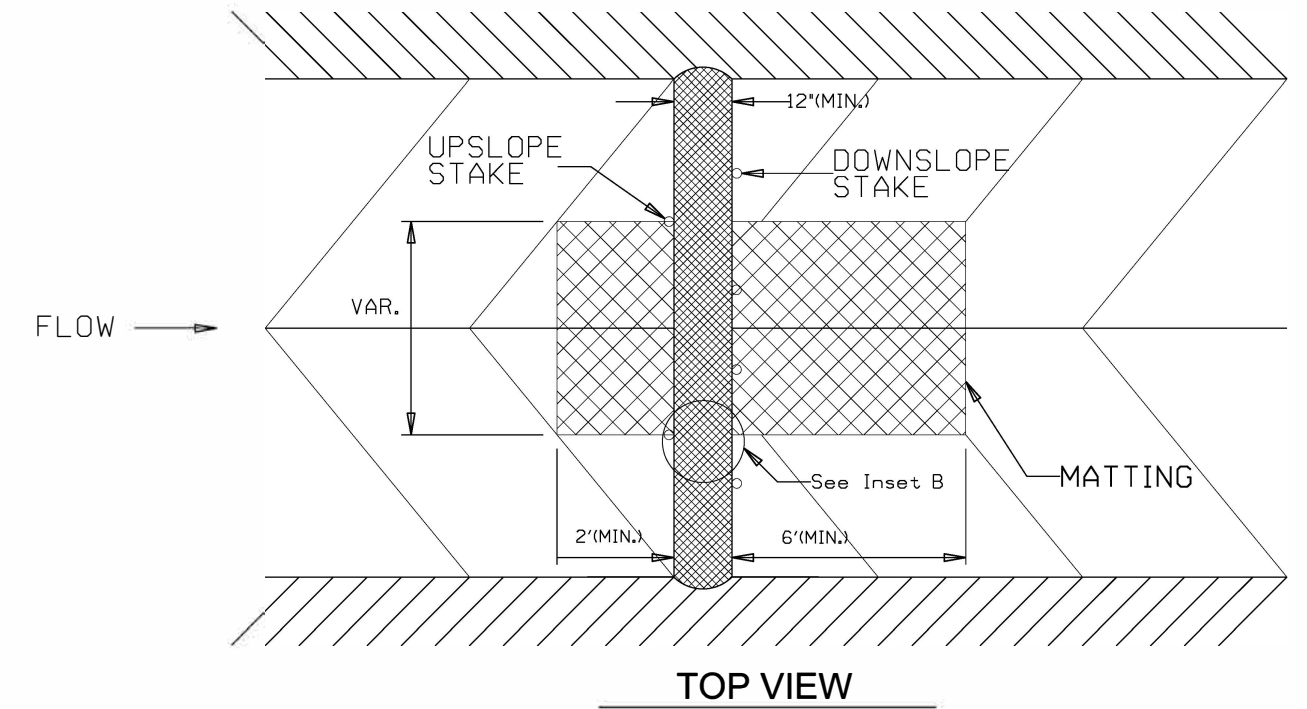
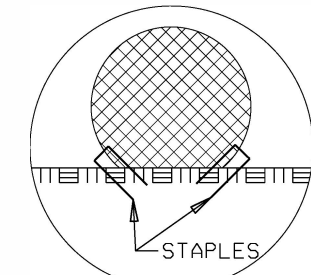
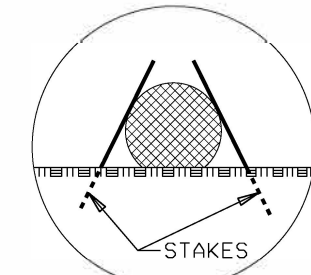

DIVISION OF HIGHWAYS  
STATE OF NORTH CAROLINA

# SOIL STABILIZATION TIMEFRAMES

SITE DESCRIPTION	STABILIZATION TIME	TIMEFRAME EXCEPTIONS
PERIMETER DIKES, SWALES, DITCHES AND SLOPES	7 DAYS	NONE
HIGH QUALITY WATER (HQW) ZONES	7 DAYS	NONE
SLOPES STEEPER THAN 3:1	7 DAYS	IF SLOPES ARE 10' OR LESS IN LENGTH AND ARE NOT STEEPER THAN 2:1, 14 DAYS ARE ALLOWED.
SLOPES 3:1 OR FLATTER	14 DAYS	7 DAYS FOR SLOPES GREATER THAN 50' IN LENGTH.
ALL OTHER AREAS WITH SLOPES FLATTER THAN 4:1	14 DAYS	NONE, EXCEPT FOR PERIMETERS AND HQW ZONES.



# SIGNING FOR RESURFACING PROJECTS

**LEGEND**  
 ┆ STATIONARY SIGN  
 ← DIRECTION OF TRAFFIC FLOW

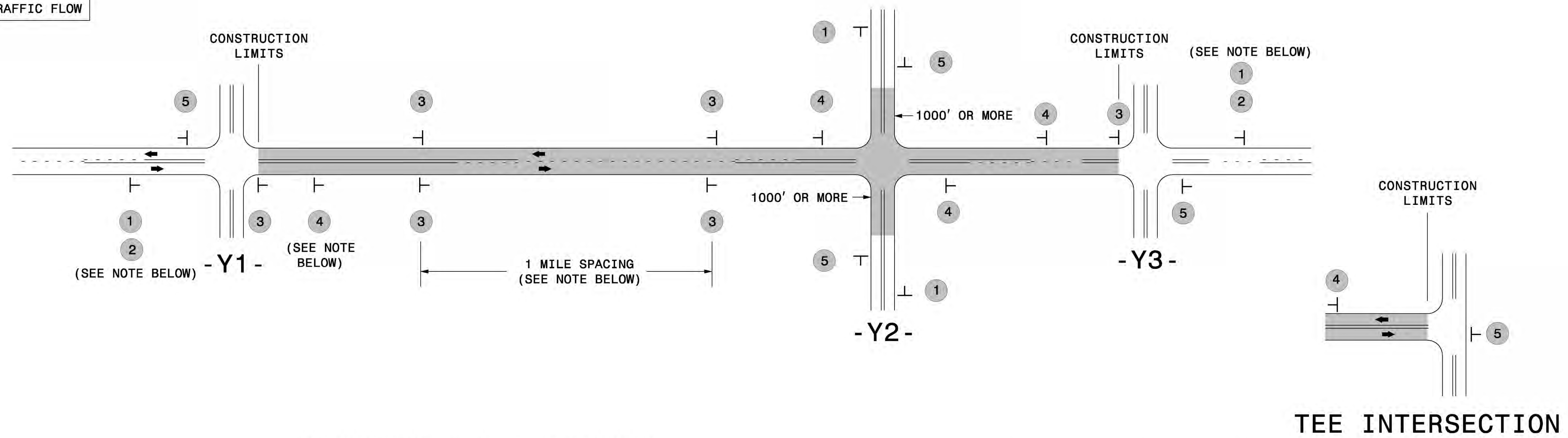

## MAINLINE (-L-) SIGNING

## -Y- LINE SIGNING

<b>SIGNING NOTES AND PLACEMENT PER DIRECTION</b>	1	 <small>W20-1 48" X 48"</small>	PLACE 1000' PRIOR TO BEGINNING OF CONSTRUCTION LIMITS. ONLY USED ON -Y- LINES IF RESURFACING LIMITS EXTEND 1000' ALONG -Y- LINE.		<p><b>NO REQUIRED STATIONARY SIGNING FOR THE FOLLOWING -Y- LINE CONDITIONS:</b></p> <ol style="list-style-type: none"> <li>1) LESS THAN 1000' OF RESURFACING ALONG -Y- LINE</li> <li>2) SUBDIVISION ROADS</li> <li>3) DEAD END ROADS</li> </ol> <p>WHEN PAVING/CONSTRUCTION ACTIVITIES PROCEED ACROSS AN UNSIGNED -Y- LINE, PORTABLE ADVANCE WARNING SIGNS SHALL BE USED ALONG THE -Y- LINE AS SHOWN BELOW. REMOVE UPON COMPLETION OF WORK.</p> <div style="display: flex; justify-content: space-around; align-items: center;"> <div style="text-align: center;">   <small>W20-1 48" X 48"</small>            PLACED 500' IN ADVANCE OF FLAGGER.         </div> <div style="text-align: center;">   <small>W20-7 A 48" X 48"</small>            PLACED 250' IN ADVANCE OF FLAGGER.         </div> </div>
	2	 <small>W7-3aP 24" X 18"</small>	#2 SIGN ONLY USED WHEN CONSTRUCTION LIMITS ARE 2 OR MORE MILES IN LENGTH. ROUND UP TO NEXT WHOLE NUMBER. (NO FRACTIONAL OR DECIMAL NUMBERS)		
	3	 <small>SP 13107 48" X 48"</small>	<ul style="list-style-type: none"> <li>- PLACE INITIALLY AT THE CONSTRUCTION LIMITS AND SPACE 1 MILE APART THEREAFTER.</li> <li>- AT TEE INTERSECTIONS INSTALL INITIALLY 1/2 MILE FROM INTERSECTION AND SPACE 1 MILE APART THEREAFTER.</li> </ul>		
	4	 <small>SP 13106 48" X 48"</small>	<ul style="list-style-type: none"> <li>- THESE ARE FOR -Y- LINES THAT ARE "THROUGH" ROADWAYS.</li> <li>- DEAD END AND SUBDIVISION ROADS ARE NOT "THROUGH" ROADWAYS.</li> <li>- INSTALL 500' +/- FROM EACH -Y- LINE APPROACH AS SHOWN ABOVE.</li> <li>- FOR MULTIPLE -Y- LINES THAT ARE SEPARATED BY 0.25 MILES OR LESS, TREAT AS A SINGLE UNIT AND INSTALL WITHIN 500' OF EACH APPROACH.</li> <li>- A MAXIMUM OF 2 SIGN SETS PER MILE. DO NOT INSTALL WHEN -Y- LINES ARE WITHIN 0.5 MILES FROM "END ROAD WORK" SIGN.</li> <li>- FOR TEE INTERSECTIONS, INSTALL WITHIN 500' +/- OF THE INTERSECTION ALONG -L- LINE.</li> </ul>		
	5	 <small>G20-2 A 48" X 24"</small>	PLACE 500' FOLLOWING THE END OF CONSTRUCTION LIMITS OR AS SHOWN WHEN WORK ENDS AT A 3-WAY TEE INTERSECTION.		

THE ABOVE SIGNS ARE ALL THAT ARE REQUIRED FOR A CONTRACTOR TO BEGIN A RESURFACING CONTRACT. ANY ADDITIONAL SIGNS REQUESTED BY NCDOT DIVISIONS SHALL BE INSTALLED WITHIN 7 BUSINESS DAYS OF THE START OF CONTRACT WORK.

**MAPS LESS THAN 2 MILES**

FOR RESURFACING MAPS WITH CONSTRUCTION LIMITS LESS THAN 2 MILES IN LENGTH, NO STATIONARY SIGNS ARE REQUIRED. USE PORTABLE "ROAD UNDER CONSTRUCTION" OR "ROAD WORK AHEAD" SIGNS IN LIEU OF STATIONARY ADVANCE WARNINGS SIGNS.

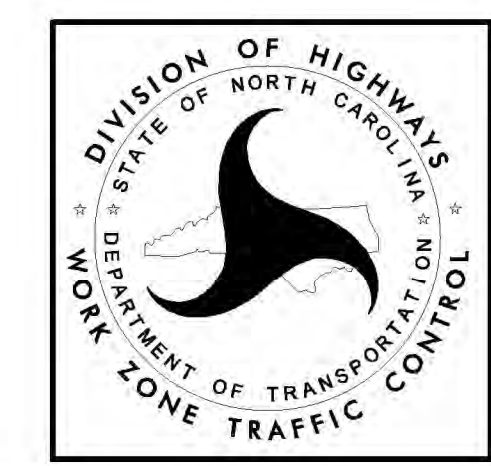

**ADVANCE WARNING SIGNS FOR RURAL AND SUBURBAN 2-LANE ROADWAY RESURFACING**

5/15/2017 5:11:10 PM \\NCDOT\GIS\Resurfacing\2L2W & AST Resurfacing Details\Resurfacing\_AdvWarn\_2Ln.dgn User:keads